

dji OSMO 360

User Manual

v1.0 2025.07

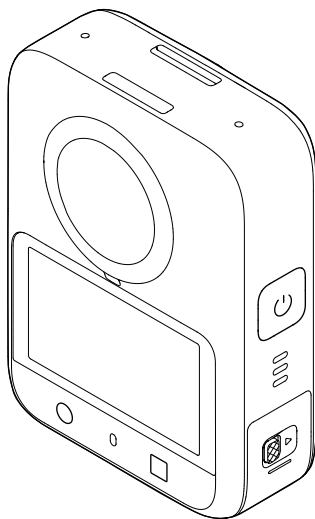



This document is copyrighted by DJI with all rights reserved. Unless otherwise authorized by DJI, you are not eligible to use or allow others to use the document or any part of the document by reproducing, transferring or selling the document. Only refer to this document and the content thereof as instructions to operate DJI products. The document should not be used for other purposes.

In the event of divergence among different versions, the English version shall prevail.

Searching for Keywords

Search for keywords such as “battery” and “install” to find a topic. If you are using Adobe Acrobat Reader to read this document, press Ctrl+F on Windows or Command+F on Mac to begin a search.

Navigating to a Topic

View a complete list of topics in the table of contents. Click on a topic to navigate to that section.

Printing this Document

This document supports high resolution printing.

Using this Manual

Legend

⚠ Important

💡 Hints and Tips

📖 Reference

Read Before Use

DJI™ provides you with tutorial videos and the following documents:

1. *Safety Guidelines*
2. *Quick Start Guide*
3. *User Manual*

It is recommended to watch all the tutorial videos and read the *Safety Guidelines* before using for the first time. Make sure to review the *Quick Start Guide* before using for the first time and refer to this *User Manual* for more information.

Video Tutorials

Go to the address below or scan the QR code to watch the tutorial videos, which demonstrate how to use the product safely:



<https://www.dji.com/360/video>

Contents

Using this Manual	3
Legend	3
Read Before Use	3
Video Tutorials	3
1 Product Profile	5
1.1 Osmo 360	6
1.2 Battery Case	7
1.3 Adapter Mount and Selfie Stick	8
2 Preparation	10
2.1 Attaching the Battery and Charging	10
2.2 Activation	10
2.3 Firmware Update	11
3 Using the Product	12
3.1 Button Features	12
3.2 Operating the Touchscreen	12
Setting the Shooting Mode	13
View/Lens Switch	14
Setting the Shooting Parameters	14
Control Center	15
3.3 Using a Selfie Stick	18
3.4 Export and Sharing	19
Transferring Files	19
Editing Panoramic Videos	19
3.5 Usage Notes	19
Lens	19
Battery	20
Underwater Usage	20
Cleaning	21
4 Specifications	22

1 Product Profile

The following accessories are included in the **Osmo 360 Adventure Combo**. They can also be purchased separately. Visit [the official store](#) for a full list of compatible accessories.

- Osmo Action Multifunctional Battery Case 2 (hereinafter referred to as "Battery Case")
- Osmo Adjustable Quick-Release Adapter Mount (hereinafter referred to as "Adapter Mount")
- Osmo 1.2 m Invisible Selfie Stick

1.1 Osmo 360

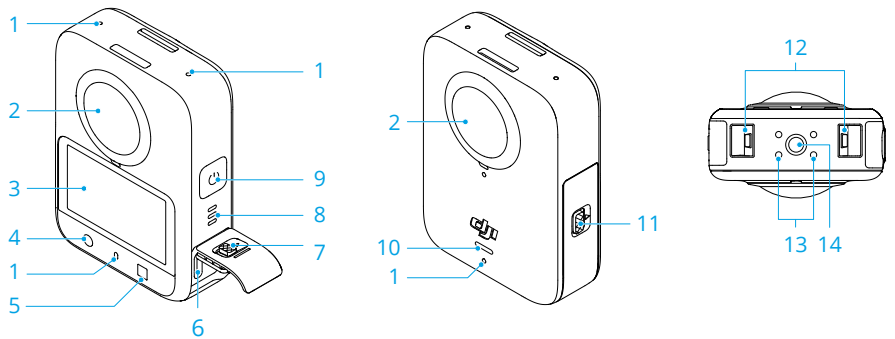

- 1. Microphone
- 2. Lens
- 3. Touchscreen
- 4. Shutter/Record Button
- 5. Function Button
- 6. USB-C Port
- 7. USB-C Port Cover Release Button
- 8. Speaker
- 9. Power/Quick Switch Button
- 10. Status LED

Blinking Pattern	Description
Solid green	Ready for shooting
Temporarily off and stays green	Taking a photo
Blinks red	Recording a video or taking a countdown photo
Blinks red three times rapidly	Powers off the camera or powers on the camera at low battery level
Blinks red and green alternately	Updating firmware

- 11. Battery Compartment Cover Release Button
- 12. Quick-Release Slot
- 13. Charging Contacts
- 14. 1/4"-20 UNC Port

1.2 Battery Case

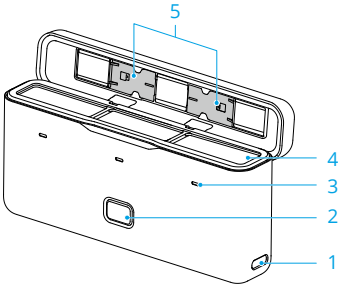

1. USB-C Port

2. Status Button

Press once to check the battery level.

3. Status LEDs

Battery Level	
Solid red	0-20%
Solid yellow	20%-80%
Solid green	80%-100%
Charging and Discharging Status	
Off	The battery in the corresponding battery port is fully charged or discharged.
Blink green successively	No battery is inserted.
Blinks red	Abnormal battery is inserted into the corresponding battery port.

4. Battery Ports

5. microSD Card Slot

 With batteries inserted, the battery case can charge the batteries or external devices such as smartphones.

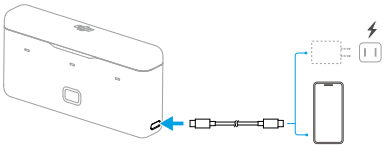

- When charging the batteries, it is recommended to use a USB-C charger that supports PD (Power Delivery) or PPS (Programmable Power Supply). The battery with the highest power level will be charged first.
- When charging external devices, the battery with the lowest power level will be discharged first.



- Place the battery case on a flat and stable surface when in use. Make sure the device is properly insulated to prevent fire hazards.
 - DO NOT touch the metal terminals on the battery ports.
 - Clean the metal terminals with a clean, dry cloth if there is any noticeable buildup.
 - The battery case is not waterproof. DO NOT place it in water or spill any liquid on the case.
-

1.3 Adapter Mount and Selfie Stick

Screw the selfie stick into the threaded hole in the bottom of the camera.

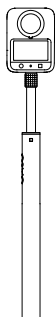

Alternatively, use the Adapter Mount to assemble the camera and the selfie stick.

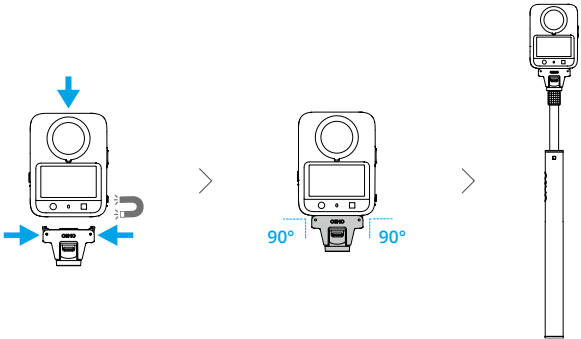

2 Preparation

2.1 Attaching the Battery and Charging

Insert the battery and completely close the cover.

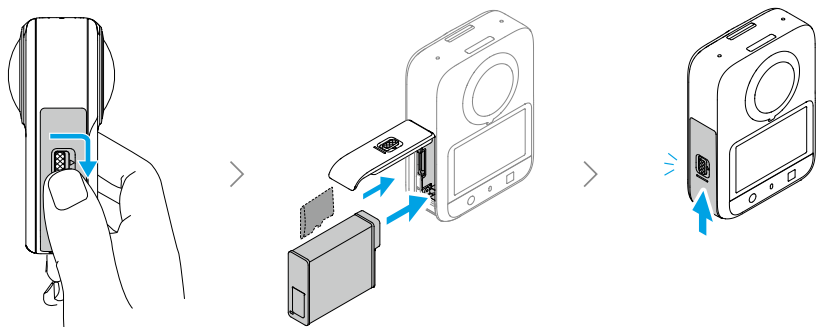

💡 The camera has 105GB of usable storage and supports microSD cards for storage expansion. Refer to [Specifications](#) for the recommended microSD cards.

It is recommended to use a USB-C charger that supports PD or PPS.

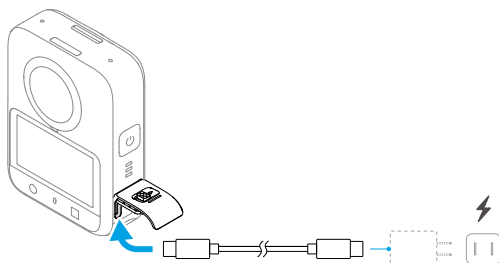

2.2 Activation

Make sure to activate the camera using DJI Mimo before first use.

1. Press and hold the power button to power on the camera.

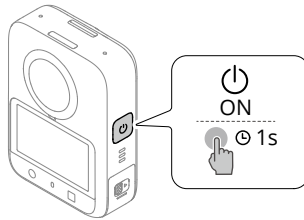

2. Scan the QR code on the screen to download the DJI Mimo app.
3. Enable Wi-Fi and Bluetooth on the mobile device.
4. Launch DJI Mimo on the mobile device, tap the camera icon to connect to the camera, and then follow the instructions to activate the camera.

When the camera is used with the DJI Mimo app, you can monitor the current camera view, set the camera parameters, and control the camera with a mobile device.

- To check the Android and iOS operating system versions supported by the app, visit <https://www.dji.com/downloads/djiapp/dji-mimo>.
- The interface and functions of the app may vary as the software version is updated. Actual user experience is based on the software version used.

- 💡 If there is a problem when connecting to DJI Mimo, follow the steps below:
1. Make sure both Wi-Fi and Bluetooth are enabled on the mobile device.
 2. Make sure the DJI Mimo app has the latest firmware version.
 3. In the liveview on the camera, swipe down from the top of the screen and tap **⚙ > Wireless Connection > Reset Connection**. The camera will reset all connections and Wi-Fi passwords.

2.3 Firmware Update

A prompt will appear in DJI Mimo when new firmware is available. Tap the prompt and follow the on-screen instructions to update the firmware.

- 💡 If the update fails, follow the steps for troubleshooting.
1. Restart the camera and DJI Mimo.
 2. Enable Wi-Fi and Bluetooth on the mobile device.
 3. Connect the camera to DJI Mimo and try the update again.
- Contact DJI Support if the update fails again.

3 Using the Product

3.1 Button Features

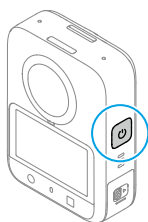

Power/Quick Switch Button

Press and hold: Power on/off.

In the liveview: Press once to enter the Quick Switch page. Press again to cycle through preset shooting modes.

- * To modify the presets, tap **•••** in the upper right corner of the Quick Switch page.

On other pages: Press once to return to the liveview.

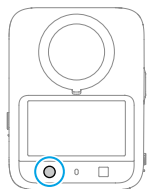

Shutter/Record Button

When powered on

Press once: Take a photo or start/stop recording.

When powered off

Press once: Power on and start recording (SnapShot). Press again to stop recording. After shooting, the camera will automatically power off if left idle for three seconds.

- * SnapShot is the quickest way to start shooting and never miss a moment of the action. By default, SnapShot applies the shooting settings from the last use of panoramic mode. To modify, enter the Control Center and tap **⚙** > SnapShot.

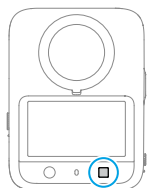

Function Button

When powered on

Press once: Switch between front and rear views (panoramic mode) / front and rear lenses (single lens mode).

Press twice: Recenter the view (panoramic mode).

When powered off

- * Make sure SnapShot is enabled for the function button. To do so, enter the Control Center and tap **⚙** > SnapShot. Scroll to **Function button** and turn on the switch. Then, you can set the mode to use.

Press once: Power on and start recording (SnapShot). Press the Shutter/Record button once to stop recording. After shooting, the camera will automatically power off if left idle for three seconds.

3.2 Operating the Touchscreen

After the camera powers on, the touchscreen shows the liveview.

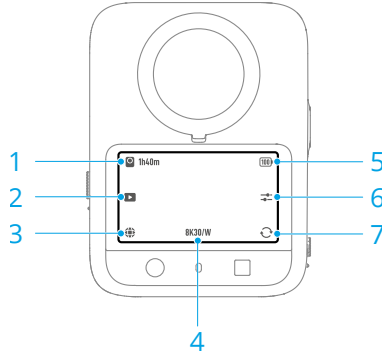

1. Storage Capacity/Remaining Recording Time

2. Playback

During playback, swipe left from the right edge of the screen to return to the liveview.

3. Shooting Mode

4. Shooting Specifications

5. Battery Level

6. Image/Audio Parameters

7. View/Lens Switch

Setting the Shooting Mode

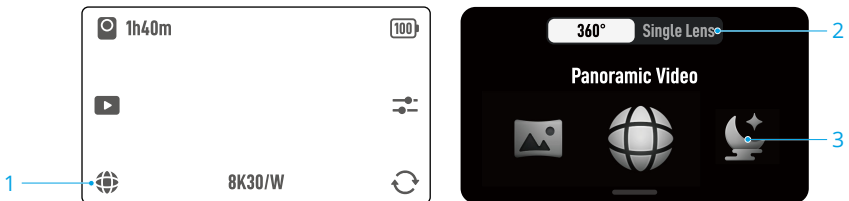

1. Tap the icon to enter the mode switch page.

2. Tap to select a lens mode:



- **360°:** Panoramic mode, which uses both lenses for shooting.
- **Single Lens:** Uses one lens for shooting.

3. Swipe to select a shooting mode. Different lens modes support different shooting modes.

Tap the selected shooting mode or swipe up from the bottom of the screen to return to the liveview.

View/Lens Switch

In 360° Mode

Slide in the center of the screen to adjust the view. Tap  to recenter the view. Tap  to switch between front and rear views.

- These operations only change what is shown on the screen and do not affect the recorded spherical video.
- Support for these operations varies by shooting mode. Refer to the actual interface.



In Single Lens Mode

Tap  to switch between front and rear lenses.

Setting the Shooting Parameters

Various parameters can be set in different shooting modes. Refer to the actual interface.

1. Swipe up from the bottom of the screen to set the parameters for each shooting mode.

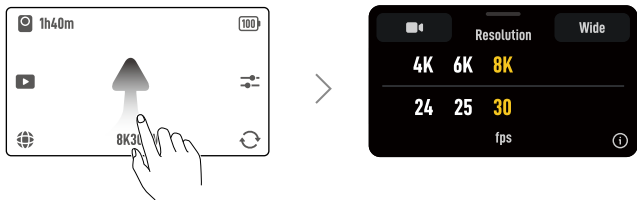

- Tap  to enable Pre-Rec or Loop Recording.

- **Pre-Rec:** When enabled, the camera will pre-record footage within the set time duration. Once the Shutter/Record button is pressed, the camera will save the latest pre-recorded footage before pressing the Shutter/Record button and keep recording, then save the footage as a whole video. This function allows the camera to save the footage before pressing the Shutter/Record button to avoid taking up too much storage space, helping capture highlights.
- **Loop Recording:** When enabled, the camera records a video by overwriting older footage with new footage at selected time intervals. This function allows the camera to save storage space, and is suitable for use in scenes where the user is waiting to capture unanticipated highlights (such as driving).
- **Tap RS** to set the EIS (Electronic Image Stabilization) mode.
 - **Off:** Records the video with the largest FOV.
 - **RockSteady:** Stabilizes footage while retaining the dynamics of movement, which is suitable for first-person perspective shooting.
 - **HorizonSteady:** Eliminates roll axis jitters within 360°. It ensures that the image remains level and stable even in scenarios involving intense bumps or turns.

Once you have set the parameters, swipe down from the top of the screen to return to the liveview.

2. In the liveview, tap  to adjust image and audio parameters. Tap **PRO** to adjust pro parameters.

 **D-Log M** is designed for professional color grading when post-editing. In high-contrast or multi-color scenarios (e.g., garden, field, etc.), it can enlarge the dynamic range for more color-grading in post-production. With D-Log M selected, you can enable Color Recovery to preview the color effects in the liveview.

Control Center

Swipe down from the top of the screen to enter the control center. Swipe left or right in the control center to view all options. Swipe up from the bottom of the screen to return to the liveview.

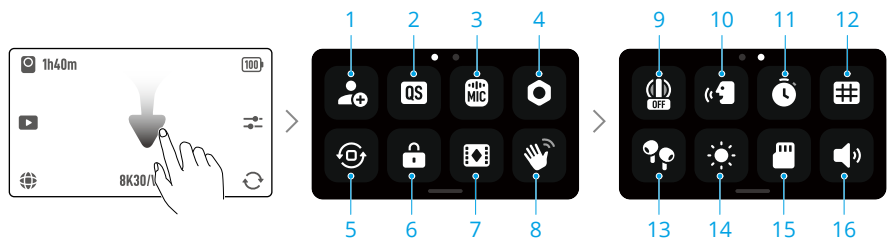

1. Custom Modes

Save the current shooting settings as a custom mode and select a scene. Next time, you can switch to this mode using the touchscreen or quick switch button.

2. Quick Switch



Select which shooting modes can be selected when pressing the Quick Switch button and enable/disable the Voice Prompt feature.

 When Voice Prompt is enabled, the camera announces the current shooting mode each time you press the Quick Switch button. When the camera is installed on a helmet or other hard-to-see locations, you can accurately select the required mode with Voice Prompt.

3. Wireless Microphone

The camera can connect to two DJI wireless microphone transmitters simultaneously. Visit the official website to view the supported models.

Follow the on-screen instructions for linking. Once linked, you can use the transmitter to control the camera to start recording, with the audio being captured by the transmitter.

-  • Visit the [DJI website](#) and refer to the user manual of the mic product for more information.
- Enter the control center, tap , and enable **Built-in Mic Audio Backup**. When enabled, the built-in microphone of the camera will also record audio while shooting video, and save the audio as a separate .wav file.
 - When the transmitter is linked to the camera, tap **Wireless Microphone** settings to adjust the audio parameters of the transmitter.

4. Settings

5. Orientation Lock

6. Screen Lock

7. Editing Assistant

Available only in panoramic video mode. If Editing Assistant is enabled before recording, you can switch to selfie view with one click when editing the video in the official software.

8. Gesture Control

When enabled, you can use hand gestures to take photos or start/stop recording.

9. Lens Protection Mode

When the camera is used with Osmo 360 Transparent Lens Protectors (sold separately), tap **Transparent Lens Protectors** before shooting.

10. Voice Control

Enable Voice Control to control the camera with voice commands.

11. Timer Shooting

12. Grid

13. Wireless Earbuds

Make sure the earbuds are in pairing status. When the device name appears in the list, tap to connect. Once connected, the camera records videos using the audio captured by the earbuds.

14. Brightness

15. Storage

Check the camera storage information. With a microSD card inserted, all the images can be stored to the microSD card. Tap **Storage** to format the internal storage or the microSD card.



Formatting will permanently delete all data. Make sure to back up all required data before formatting.

16. Sounds Volume

3.3 Using a Selfie Stick

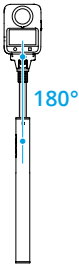
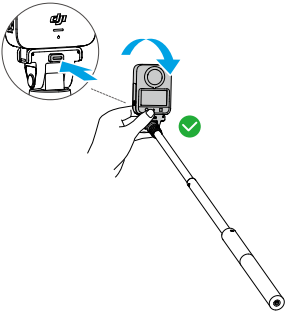
Lens Mode	Selfie Stick Position	Effect
360° (Panoramic mode)		The selfie stick is invisible in the frame.
Single Lens	 <p><i>Press and hold the button on the back of the Adapter Mount, rotate to the end position, and then release the button.</i></p>	The selfie stick remains in the frame. The self- ie image is captured at the optimal angle and in sharp focus.

In 360° > Selfie Mode, the camera records only the area on the selfie stick side. You can use the official editing software to create wide-angle videos with the invisible selfie stick effect.

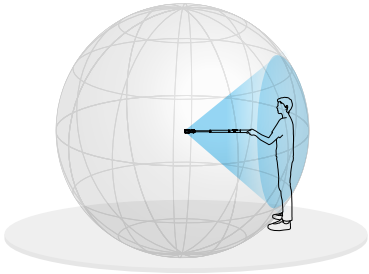

3.4 Export and Sharing

Transferring Files

Transferring Files to a Mobile Device

1. Enable Wi-Fi and Bluetooth on the mobile device. Launch DJI Mimo and tap the camera icon on the home screen.
2. Connect the camera to DJI Mimo, tap the Playback icon to preview photos and videos. Tap the ⬇ icon to download photos and videos.

Transferring Files to a Computer

Power on the camera and connect it to a computer using the provided cable. When connected to a computer, a pop-up will appear. Tap **Transfer File: USB** to download the files from the camera to the computer. When transferring a file, the camera cannot take photos or record videos.

💡 Reconnect the device to the computer if a file transfer is interrupted.

Editing Panoramic Videos

Panoramic videos shot with the camera must be edited before you can share them as regular videos. Use DJI Mimo on your phone for quick editing or professional software on your computer for advanced editing.

Watch the tutorial videos for details.



<https://www.dji.com/360/video>

3.5 Usage Notes

Lens

1. Keep the surface clean and scratch-free to avoid affecting image quality.
2. After shooting, attach the rubber lens protector to the camera. Keep the inside of the protector clean to prevent dirt or scratches.

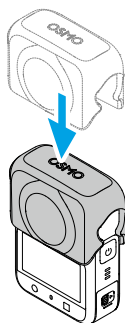

Battery

1. DO NOT use non-official batteries. DJI takes no responsibility for any damage caused by non-official batteries.
2. Discharge and charge the battery completely once every three months to keep it in good condition.
3. When the battery voltage is too low, the battery will enter low-power state. Charging the battery will exit low-power mode.
4. DO NOT store the battery for an extended period of time after fully discharging. Otherwise, the battery may over-discharge and cause irreparable damage.
5. Discharge the battery to 40-65% if it will not be used for 10 days or more. This can greatly extend the battery life.

Underwater Usage

-
- ⚠ • The camera unit can be used underwater at depths of up to 10 m.
- The camera may stitch images incorrectly when shooting panoramic videos underwater because water bends light differently than air. It is not recommended to use the camera alone for underwater shooting.
-
1. Make sure the battery and battery compartment are dry and clean before inserting the battery. Otherwise, it may affect the battery contact and waterproofing ability. Make sure the battery compartment cover is firmly fastened after the battery is inserted. Note that the red marks should not be visible after the cover is properly fastened.
 2. Avoid jumping into water at high speed with the product. Otherwise, the impact may result in water seepage.

3. Rinse the camera with tap water after using it underwater. Allow it to dry naturally before using again. Wipe the surface of the camera with a soft and dry cloth.
4. DO NOT dry the camera with hot air using a hair dryer, otherwise the microphone membrane and the built-in breathable membrane will rupture, and the camera will no longer be waterproof.
5. After using the camera in water, open the battery compartment cover facing downward to prevent water from entering the gaps in the battery compartment if you need to replace the battery. Wipe off any water droplets in the gaps of the battery compartment and clean the red waterproof rubber ring to prevent any foreign objects from remaining. Otherwise, it will affect the waterproof performance during subsequent use.

Cleaning

1. DO NOT spill any liquids containing alcohol or cleansing solution on the camera.
2. If the holes of the microphone, heat dissipation slots, or other parts of the camera are blocked by sand or other foreign matter, rinse with fresh water while the camera is in a sealed waterproof state.
3. Clean the lens with a lens cleaning pen, lens air blower, or lens cleaning cloth.
4. Clean the battery and battery compartment with a clean, dry cloth.
5. Make sure the quick-release slots on the camera are clear of dust and sand when attaching the Quick-Release Adapter Mount.

4 Specifications

Visit the following website for specifications.

<https://www.dji.com/360/specs>



Contact

DJI SUPPORT

This content is subject to change without notice.
Download the latest version from



<https://www.dji.com/360/downloads>

If you have any questions about this document, please contact DJI by sending a message to DocSupport@dji.com.

DJI and OSMO are trademarks of DJI.

Copyright © 2025 DJI All Rights Reserved.